

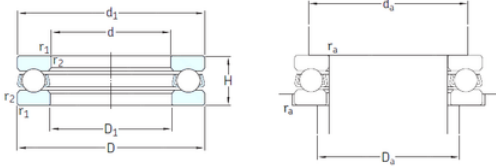

# PRD BEARINGS LLC



## 51100 Thrust Ball Bearing 10X24X9 Thrust Bearings Axial Bearing 51100 51101 51102 SKF NTN NSK

Bearing No. 51100

51100 Bearing 2D drawings and 3D CAD models

Size	10x24x9 mm
Bore Diameter	10 mm
Outer Diameter	24 mm
Width	9 mm
d	10 mm
D	24 mm
H	9 mm
d1	24 mm
r1 min.	0,3 mm
r2 min.	0,3 mm
D1	11 mm
da min.	19 mm
Da max.	15 mm
ra max.	0,3 mm
Weight	0,02 Kg
Basic dynamic load rating (C)	9,95 kN
Basic static load rating (C0)	15,3 kN
Fatigue load limit (Pu)	0,56
Reference speed	9500 r/min
Limiting speed	13000 r/min
Category	Thrust Ball Bearing
Inventory	0.0
Manufacturer Name	SKF
Minimum Buy Quantity	N/A



## PRD BEARINGS LLC

Weight / Kilogram	0.024
EAN	7316577006493
Product Group	B00308
Rolling Element	Ball Bearing
Thrust Bearing	Yes
Single or Double Direction	Single Direction
Banded	No
Cage Material	Steel
Precision Class	ABEC 1   ISO P0
Component Description	Roller Assembly Plus Raceways
Other Features	Single Row
Long Description	10MM Bore 1; 11MM Bore 2; 24MM Outside Diameter; 9MM Height; Ball Bearing; Single Direction; Not Banded; Steel Cage; ABEC 1   ISO P0 Precision
Inch - Metric	Metric
Category	Thrust Ball Bearings
UNSPSC	31171507
Harmonized Tariff Code	8482.10.50.08
Noun	Bearing
Keyword String	Ball Thrust
Manufacturer URL	<a href="http://www.skf.com">http://www.skf.com</a>
Manufacturer Item Number	51100
Weight / LBS	0.052
Outside Diameter	0.945 Inch   24 Millimeter
Bore 1	0.394 Inch   10 Millimeter
Bore 2	0.433 Inch   11 Millimeter
Overall Height with Aligning Washer	0 Inch   0 Millimeter
Height	0.354 Inch   9 Millimeter
bore diameter:	10 mm



## PRD BEARINGS LLC

static load capacity:	15.3 kN
outside diameter:	24 mm
dynamic load capacity:	9.95 kN
overall width:	9 mm
maximum rpm:	13000 RPM
thrust bearing type:	Single-Direction
cage material:	Steel
outside diameter design:	Straight
fillet radius:	0.3 mm
separable or banded:	Separable
series:	511
precision rating:	ABEC 1 (ISO Class Normal)
$d_1$	24 mm
$D_1$	11 mm
$r_{1,2}$ min.	0.3 mm
$d_a$ min.	19 mm
$D_a$ max.	15 mm
$r_a$ max.	0.3 mm
Basic dynamic load rating C	8.71 kN
Basic static load rating $C_0$	12.2 kN
Fatigue load limit $P_u$	0.45 kN
Minimum load factor A	0.0012
Mass bearing (including seat washer where applicable)	0.02 kg